

# Technical data sheet

Product features



## Substructure closed

Model

SAP Code

00009372

– Material: AISI 304



# Technical data sheet

Technical drawing



Substructure closed

Model

SAP Code

00009372

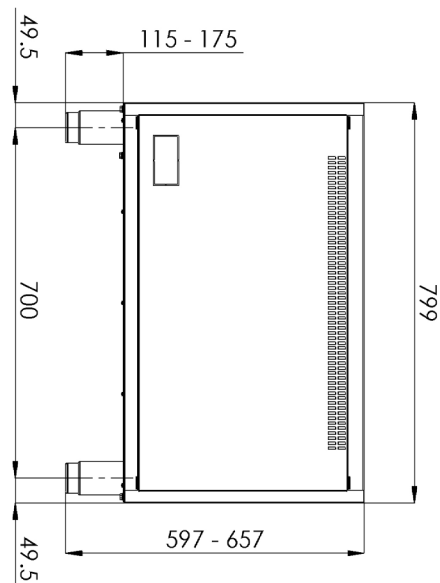
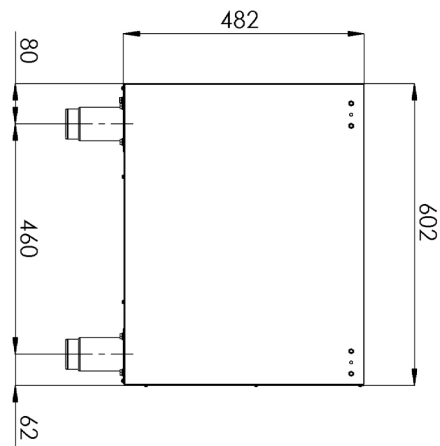

# Technical data sheet

Technical parameters



## Substructure closed

**Model**

**SAP Code**

00009372

**1. SAP Code:**

00009372

**9. Gross Weight [kg]:**

20.00

**2. Net Width [mm]:**

800

**10. Material:**

AISI 304

**3. Net Depth [mm]:**

730

**11. Adjustable feet:**

Yes

**4. Net Height [mm]:**

600

**12. Exterior color of the device:**

Stainless steel

**5. Net Weight [kg]:**

15.00

**13. Material of feet:**

stainless steel

**6. Gross Width [mm]:**

840

**14. Surface finish:**

polished stainless steel

**7. Gross depth [mm]:**

750

**15. Construction type of device:**

Stationary

**8. Gross Height [mm]:**

620